

ORDER FROM:
GRAY TECHNOLOGIES
13062 HWY 290 WEST; AUSTIN, TEXAS 78737
PH: 512.264.2075 INFO@GRAY-TECH.COM WWW.GRAY-TECH.COM

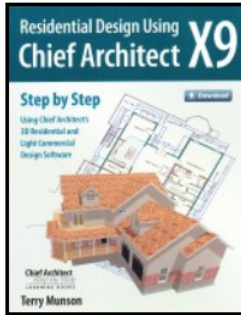

Residential Design Using Chief Architect X9

\$74.95 Softcover
\$58.95 Digital Edition

You Will Create This Home Using the Tutorials in the Book to Include Framing, Interior Design, Electrical, Stepped Foundation (part crawl space, part full basement), Dormers, Decks and Balconies, Site Plan and Landscaping, Schedules, Construction Drawings, and More!

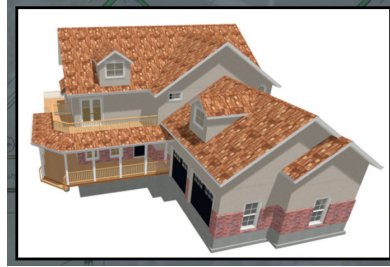

This book is fully updated for the release of Chief Architect X9 Premium. The step by step tutorials are fun and easy to grasp as they guide you through the design process, from setting up your drawing, drawing walls, doors, windows, foundation, roof, to creating finished construction documents. By the time you have finished the book tutorials you will have drawn a beautiful modern 2-story residence, complete with a walk-out basement, decks, and landscaping. You will also become proficient with CA X9's new and enhanced features including the ability to create plant shelves, shorter closets, wall niches, auto L-shaped and U-shaped stairs. The book is loaded with concise explanations with step by step tutorials that will give you a hands-on experience in developing a real home design project from start to finish. Other new features that are covered by this book include the control of UI button size, the ability to fully control the display of items in relation to each other, a library painter function, improved render features, the ability to snap dimensions to countertops, polyline solids, and slabs, and many other new enhancements and tools that will make your home design work more proficient and professional.

Coverage includes:

- Finding your way around the Chief Architect interface
- Managing your drawing projects
- Creating the building shell
- Develop a quick start vacation cabin plan
- Developing and working with stairs, roofs, decks, and bath and kitchen design
- Framing
- Adding a stepped foundation and applying a monolithic slab to the garage
- Dormers
- Adding electrical and lighting
- Interior Design
- Developing elevations and cross sections
- Creating a site plan and developing the terrain
- Working Drawings
- Applying different materials
- Printing
- Color Renderings
- Walkthroughs
- Ray Tracing
- Layers
- Annotation Sets
- Schedules
- Dimensioning and Text
- Text Styles
- **Working files and bonus chapters are included and can be downloaded from the Home page.**